

FEEK'S FIRST PLAT OF
ISLAND FARM
6625

FEEK'S FIRST PLAT OF
ISLAND FARM
6625

MILLER
LAKE

WINDMILLS

W.C. ROAD
M. STROUD

045-041
245-96

5-P

015-041

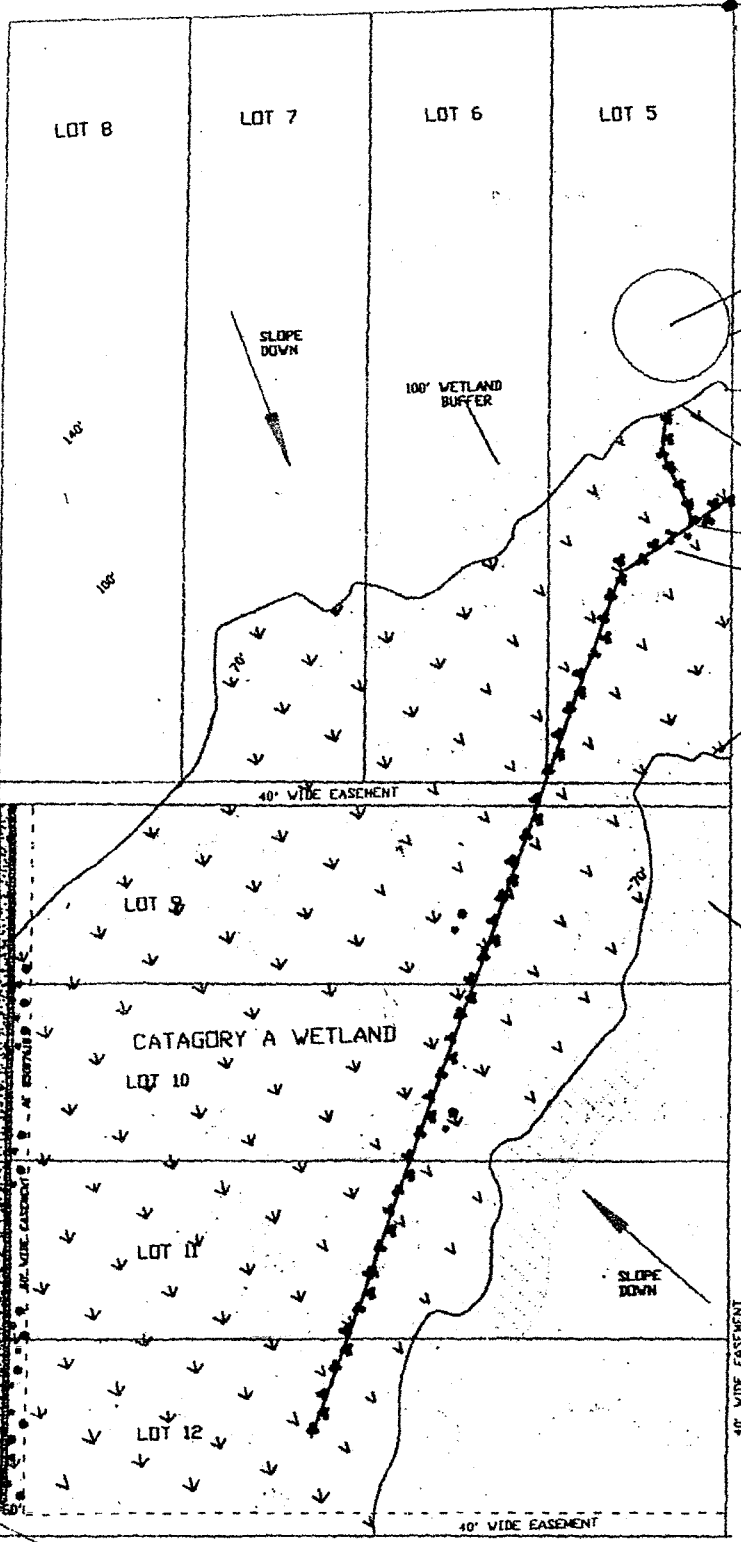

COLES ROAD

LOT 8 LOT 7 LOT 6 LOT 5

WELL SITE
100' WELL RADIUS

SLOPE DOWN

100' WETLAND BUFFER

WETLAND BOUNDARY

EXISTING DRAINAGE DITCH 4' X 1800'

NATIVE TREE SPECIES

WETLAND BOUNDARY

40' WIDE EASEMENT

LOT 9

NATIVE TREE SPECIES

12' CULVERT PROPOSED

CATAGORY A WETLAND
LOT 10

100' WETLAND BUFFER

PHASE I PROPOSED 18' WIDE ACCESS ROAD APW 03-0263

12' CULVERT PROPOSED

LOT 11

SLOPE DOWN

60' X 120' EASEMENT # 368799

PROPOSED 24' CULVERT

LOT 12

40' WIDE EASEMENT

1281.07'

PHASE II PROPOSED ADDITIONAL 9.5' WIDE BASE ROAD WIDTH

40' WIDE EASEMENT

EWING ROAD

CRSTOL ACRES

